

EJOv1TL30 EPB & James Hardie Oblique™ Weatherboard - Vertical Two Way FRR

External Wall - Timber Frame Load Bearing

System Number	Lining Suffix	FRR	Insulation	Noise Control STC	Lining Requirement
EJOv1TL30	-F10	30/30/30	R2.2 glass wool	46	1 x 10mm EPB FireSmart® on Internal side James Hardie Oblique™ Weatherboard vertical to External side

Framing, Wall Height, Load and Framing Dimension

Timber framing to comply with relevant sections and clauses of NZBC B1: Structure and NZBC B2: Durability. Timber framing must be in accordance with NZS3604 stud tables for load bearing or non-load bearing partitions. Furthermore;

- Minimum framing dimension is 90 x 45mm.
- Nogs must be in place at a maximum of 800mm centres.
- Maximum stud spacing's are 600mm centres.
- The fire rated walls built close to boundary are also required to achieve post fire stability in either direction in accordance with the NZBC verification method B1/VM1, paragraph 2.2.4

Refer to latest James Hardie Fire & Acoustic Design Manual figures and tables for further detail.

Underlay

For the type of allowable underlay refer to table below.

	EH Wind Zone	Other Wind Zone
Buildings <10m	Rigid Air Barrier	Flexible Underlay
Buildings >10m	Rigid Air Barrier	Rigid Air Barrier

Fire Retardant Flexible Underlay

Install any Fire Retardant Flexible Underlay beneath the claddings, that complies with Table 23 of E2/AS1 and has a flammability index not exceeding 5.

Rigid Air Barrier

One layer of James Hardie RAB™ Board fixed to entire framing.

6mm RAB™ Board : Use 40 x 2.8mm fibre cement nail at 200mm centres

9mm RAB™ Board : Use 50 x 2.8mm fibre cement nail at 200mm centres

Fixing to be 12mm from sheet edges. Reference to be made to the James Hardie Home RAB™ Pre-Cladding & RAB™ Board Installation Manual. Alternative Rigid Air Barrier systems are allowable.

Cavity Batten

Use a 20mm James Hardie Horizontal Timber Cavity Batten. Refer to Oblique™ Weatherboard 14mm Vertical Installation Technical Specification for installation instructions.

Oblique™ Weatherboard Cladding - Vertical

James Hardie Oblique™ Weatherboard cladding fixed vertically to external side of the timber framing. Refer to both Oblique™ Weatherboard 14mm Vertical Installation Technical Specification AND the James Hardie Fire & Acoustic Design Manual for information regarding fixing and finishing.

Wall Insulation

Insulation must be installed between studs and nogs. Use 90mm thick R2.2 glass wool insulation.

EPB® Plasterboard Lining

One layer of 10mm EPB FireSmart lining to internal side of framing. Vertical fixing only permitted. Use full height sheets where possible when fixing vertical. All sheet joints must be fixed over solid timber framing. Sheets shall be touch fitted.

Fixing of EPB® Plasterboard Internal Linings

Fasteners

41mm x 6g High Thread Drywall Screws

Fastener Centres

Fix at 300mm centres around sheet perimeter and up all intermediate studs. Place fasteners 50mm from sheet corners along the top and bottom plates. On end studs place additional fasteners 50-60mm vertically and no close than 10mm from plate to stud connections.

Place fasteners no closer than 12mm from the sheet edges and 18mm from sheet ends. Place fasteners at 200mm centres where sheet end butt joints occur.

Jointing and Finishing of EPB® Plasterboard

All fastener heads stopped and all sheet joints reinforced with paper jointing tape and stopped. All in accordance with EPB® Plasterboard Installation Guide.

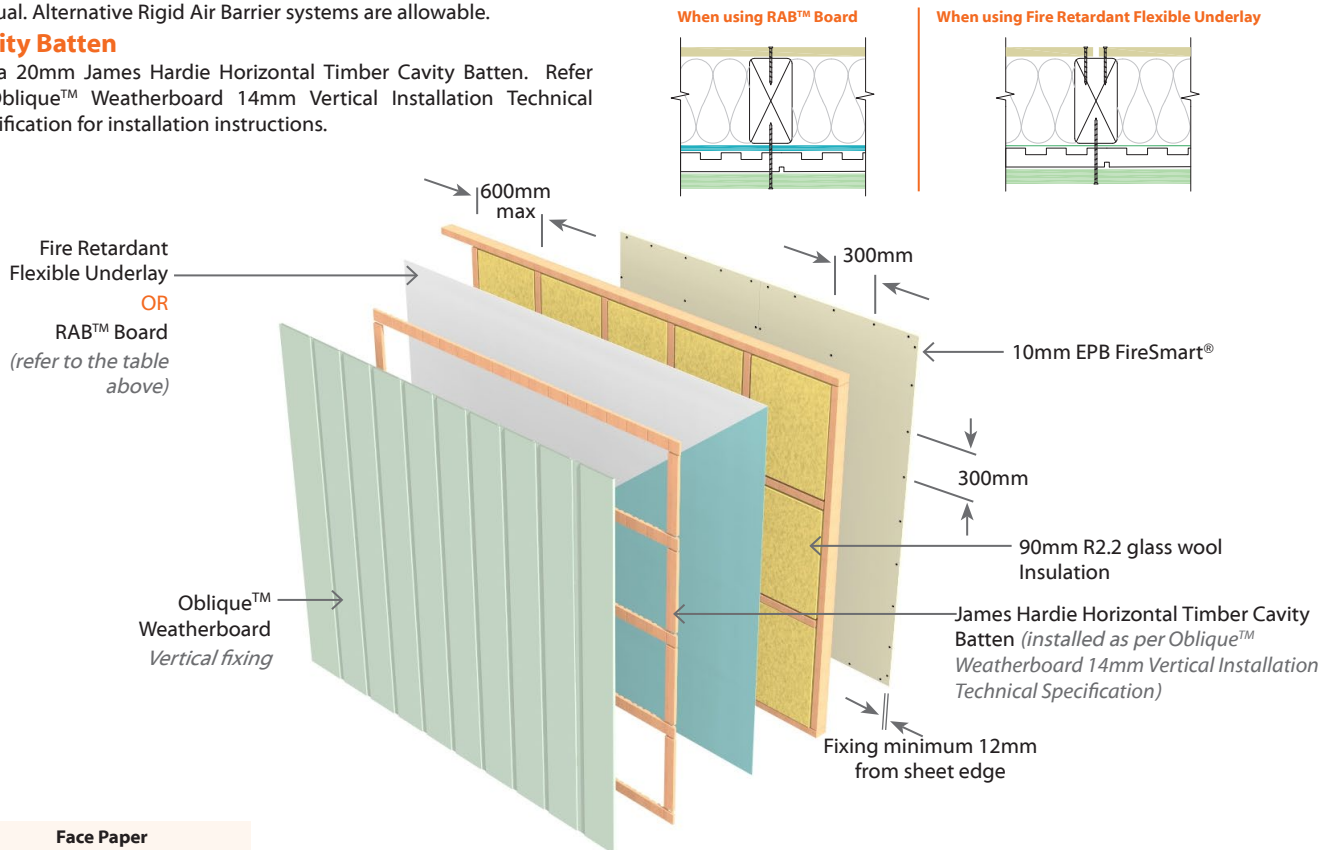

When using RAB™ Board

When using Fire Retardant Flexible Underlay

Face Paper	Product Identification Code
10mm EPB FireSmart®	F10

N.B. The above drawings are for illustrative purposes only.

