



EPB Plasterboard Steel Stud Bracing

July 2025

System Number	Lining Requirement	Min. Element Length (m)	BU/m		Minimum Panel Hold downs	Page
			Wind	Earth-quake		
ECS-H	10mm EPB Standard Plasterboard on one side	0.4	65	60	10kN	2
		0.8	75	65		
		1.2	85	70		
ECSSH	10mm EPB Standard Plasterboard on both side	0.4	80	90	12kN	2
		0.8	95	95		
		1.2	115	100		
ECM-H	10mm EPB MultiSmart on one side	0.4	75	80	12kN	2
		0.8	95	90		
		1.2	115	95		
ECMPH	10mm EPB MultiSmart on one side & 7mm D-D Plywood on the other	0.4	100	95	12kN	3
		0.8	115	110		
		1.2	130	120		

System Number	Lining Requirement	Min. Element Length (m)	BU/m		Minimum Panel Hold downs
			Wind	Earth-quake	
ECS-H	10mm EPB Standard Plasterboard on one side	0.4	65	60	10kN
		0.8	75	65	
		1.2	85	70	
ECSSH	10mm EPB Standard Plasterboard on both side	0.4	80	90	12kN
		0.8	95	95	
		1.2	115	100	
ECM-H	10mm EPB MultiSmart on one side	0.4	75	80	12kN
		0.8	95	90	
		1.2	115	95	

FRAMING

NZBC B1: Structure

NZBC B2: Durability

Steel framing dimensions and height as determined by Specific Engineering Design. C Section studs shall have a minimum thickness of 0.75mm and minimum nominal depth of 90mm and 35mm wide flanges.

BOTTOM PLATE FIXING

Timber Floor – 5mm washer as shown below, fixed to timber floor using a 12mm x 100mm galvanised coach screw or 4 x 75mm Type 17 class 3 screws.

Concrete Floor – 5mm washer as shown below, fixed to concrete slab using a proprietary concrete anchor with a minimum uplift capacity (as listed in table above) take into consideration concrete slab thickness (internal walls) and edge distance (external walls).

PLASTERBOARD WALL LININGS

Refer Table at top of page

Vertical or horizontal fixing permitted. Use full height sheets where possible. Sheets shall be touch fitted

FASTENERS

32mm x 6g Drywall Screws

FASTENING CENTRES

Perimeter of bracing element: as per the diagram below

Centre of sheets:

Vertical Fixing – Fasteners at 300mm centres at sheet joints in tapered sheet edges in the field of the bracing elements

Horizontal Fixing – Place single fasteners in the tapered edge where sheets cross studs.

Use daubs of adhesive at 300mm centres to intermediate studs in the body of the sheets.

Place fasteners 12mm from paper bound edges and 18mm from cut edges.

JOINTING

All fastener heads stopped and all sheet joints paper-tape reinforced and stopped in accordance to EPB Plasterboard Installation Guide

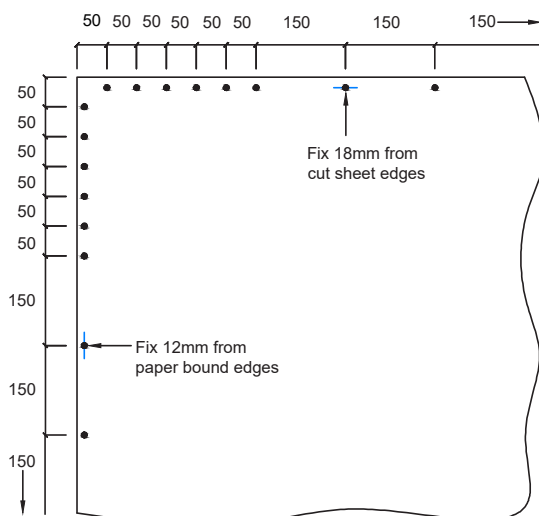

Corner Pattern

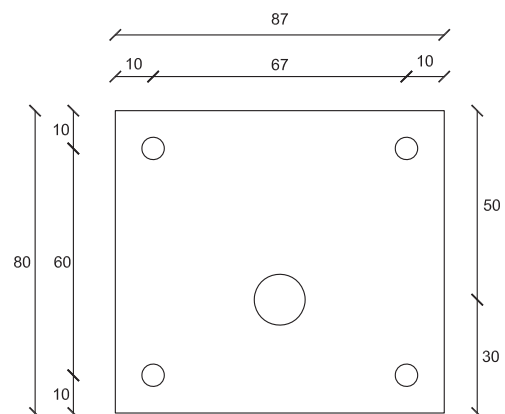

Hold down Washer

System Number	Lining Requirement	Min. Element Length (m)	BU/m		Minimum Panel Hold downs
			Wind	Earth-quake	
ECMPH	10mm EPB MultiSmart on one side & 7mm D-D Plywood on the other	0.4	100	95	12kN
		0.8	115	110	
		1.2	130	120	

FRAMING

NZBC B1: Structure

NZBC B2: Durability

Steel framing dimensions and height as determined by Specific Engineering Design. C Section studs shall have a minimum thickness of 0.75mm and minimum nominal depth of 90mm and 35mm wide flanges.

BOTTOM PLATE FIXING

Timber Floor – 0.95BMT bracket and 5mm washer as shown below, fixed to timber floor using a 12mm x 100mm galvanised coach screw or 4 x 75mm Type 17 class 3 screws..

Concrete Floor – 0.95BMT bracket and 5mm washer as shown below, fixed to concrete slab using a proprietary concrete anchor with a minimum uplift capacity (as listed in table above) take into consideration concrete slab thickness (internal walls) and edge distance (external walls).

PLASTERBOARD WALL LINING

Refer Table at top of page

Vertical or horizontal fixing permitted. Use full height sheets where possible. Sheets shall be touch fitted

FASTENERS (BOTH PLASTERBOARD & PLYWOOD)

32mm x 6g Drywall Screws

FASTENING CENTRES

Perimeter of bracing element: as per the diagram below

Centre of sheets:

Vertical Fixing – Fasteners at 300mm centres at sheet joints in tapered sheet edges in the field of the bracing elements

Horizontal Fixing – Place single fasteners in the tapered edge where sheets cross studs.

Use daubs of adhesive at 300mm centres to intermediate studs in the body of the sheets.

Place fasteners 12mm from paper bound edges and 18mm from cut edges.

FIXING OF PLYWOOD LINING

Vertical sheet fixing only. within the bracing element place fasteners at 150mm centres along all sheet joins and at 300mm centres to intermediate framing. Plywood to comply with AS/NZS 2269.0:2012

JOINTING

All fastener heads stopped and all sheet joints paper-tape reinforced and stopped in accordance to EPB Plasterboard Installation Guide

